

Conduit Gate Valve ASR-W

General information

Accessories for RMA valves

Easy-to-operate gears are described or illustrated in this brochure.

Actuators are, of course, also available as well as other accessories. For specific information concerning installation and positioning, please contact us.

When connection dimensions are different from our standard ratings, corresponding reducers may be provided by us.

Technical variations to RMA valves

No brochure is complete. We strive to accommodate your specific requirements or deviations from our standard ratings.

RMA quality

Products manufactured in the RMA works are renowned for their high quality.

We have DIN ISO 9001 approval, as well as many other customer and official approvals in compliance with German and International Standards.

Of course, all fittings illustrated in this brochure conform to national as well as international standards, e.g. in Germany to DVGW and TÜV Standards as applicable.

RMA manufacturing line

We have specialized in a wide range of high quality products for the transport of media in pipelines. Examples of the various product groups are illustrated on the back of this brochure.

For further details or specific brochures please contact us.

In addition to our own RMA products, we also manufacture special components according to customer specifications.

Technical modifications reserved.

PN 4 - 25

Description

1. General Characteristics

The RMA gate valve type "ASRW" is an extremely robust welded steel, dust-resistant shut-off valve, which requires virtually no maintenance and is used for installation in gas pipelines (coking plants, fission and natural gas).

2. Construction / Function

This gate valve has a plane-parallel machined and floating mounted nickel plated close-plate with a borehole, so that in the open position a smooth flowing product and full piggable passage without swirl is obtained. (With PE-connection only upon request.)

A special combination seal with inserted steel core and vulcanised wiper ring on both sides of the plate guarantees, together with the precision-machined sealing surface of close plate, a lasting seal, in case of pressurizing on one or two sides, or in open position.

The seal resists odorised natural gas as well as condensations, methanol and glycol.

The wiper ring vulcanised into sealing facility prevents dirt accumulating on sealing surface as well as passage of dirt in both, open and closed position.

Flow direction is arbitrary.

This gate valve ensures a permanent and easy operation.

3. Corrosion prevention

The outer shell has as standard a PUR (polyurethane) coating.

4. Bleed pipe

See ROTARY GATE VALVE Type "DSR".

5. Reception test

DIN 3230 part 5 test group PG 3

6. Additional document

Operating-, Maintenance-, and Repair Instructions.

Conduit Gate Valve ASR-W

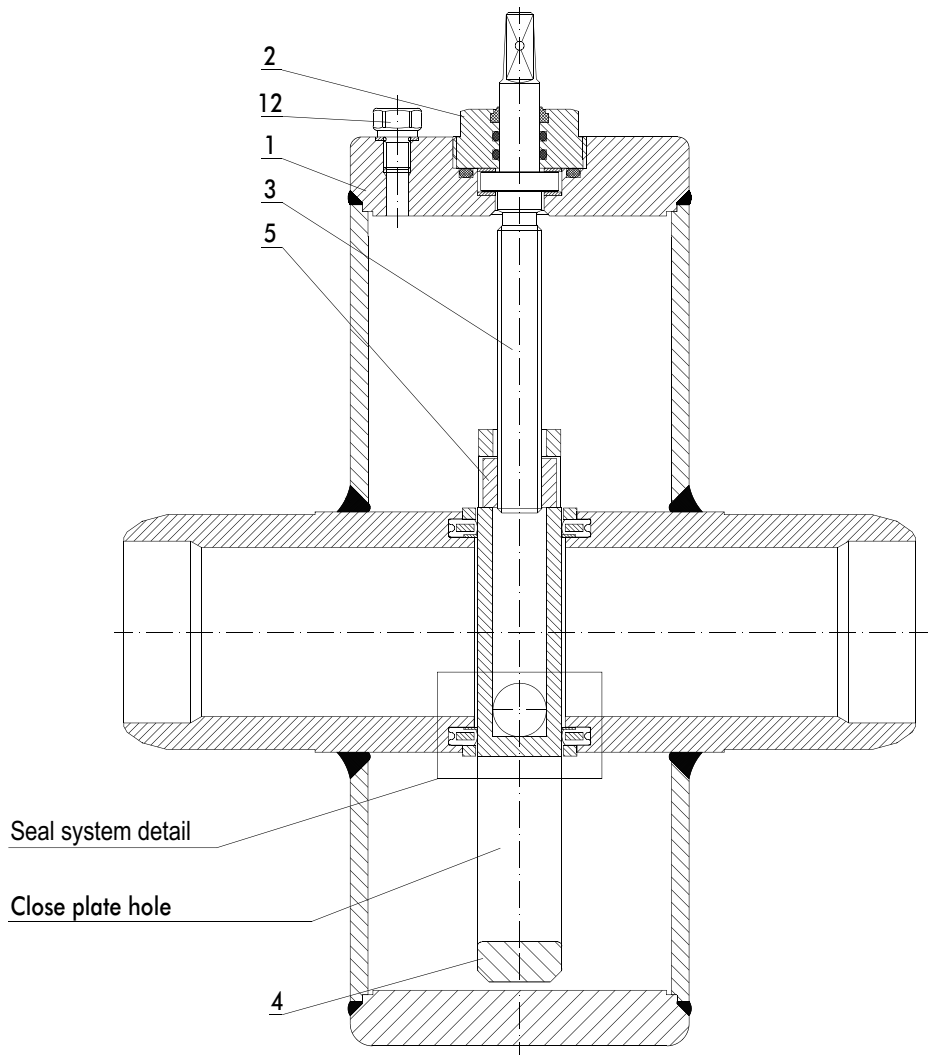
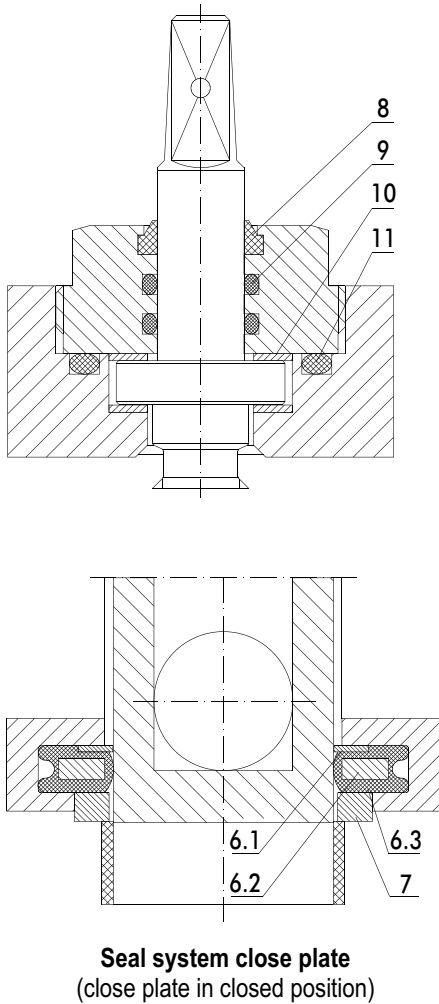

Pos. Item	Description
1	Housing
2	Packing nut
3	Spindle
4	Close plate
5	Spindle nut
6.1	Wiper ring
6.2	Steel ring
6.3	Perbunane
7	Guide ring
8	Wiper ring
9	O-ring
10	Wearing washer
11	O-ring
12	Drain plug

Conduit Gate Valve ASR-W

with steel weld ends

Description	Material
Housing	S355J2H (St 52.0)
Union pipe	S355J2H (St 52.0)
Close plate	EN-GJS-500-7 (GGG-50)

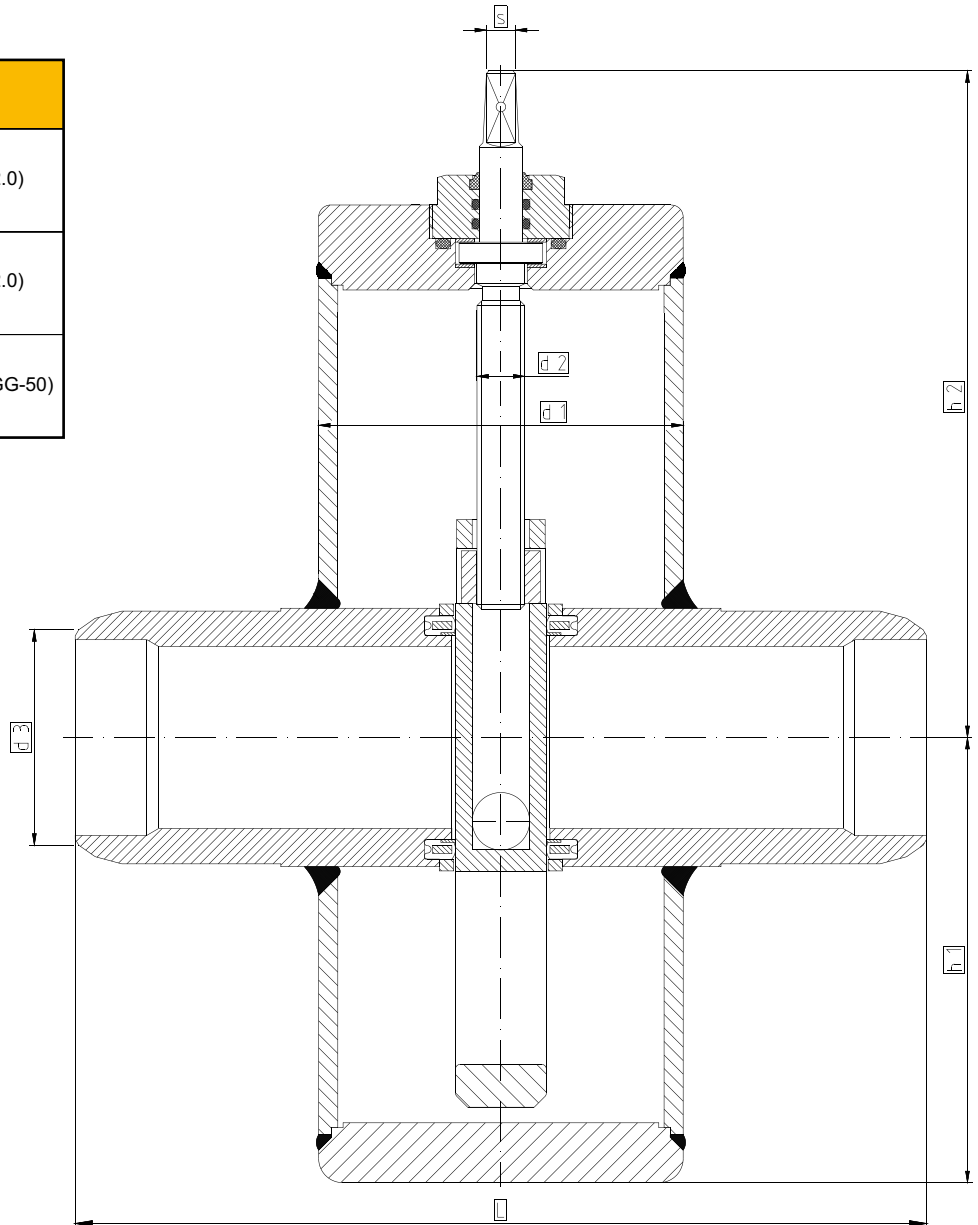

Conduit gate valve DN 300 with lifting lugs

ASR PN4/6	DN 50	DN 80	DN 100	DN 150	DN 200	DN 300
s	12	12	12	12	19	19
d ¹	121	152	191	241	324	419
d ²	18	20	22	24	26	26
d ³	60.3	88.9	114.3	168.3	219.1	323.9
h ¹	129	179	215	312	385	554
h ²	229	279	332	425	540	763
L=length EN 12982 Reihe 5	292	356	432	559	660	838
Turn/stroke	17	24	24	35	45	67
Weight in kg	20	33	63	110	200	330

Conduit Gate Valve ASR-W

with PE-HD (PE 100) connection

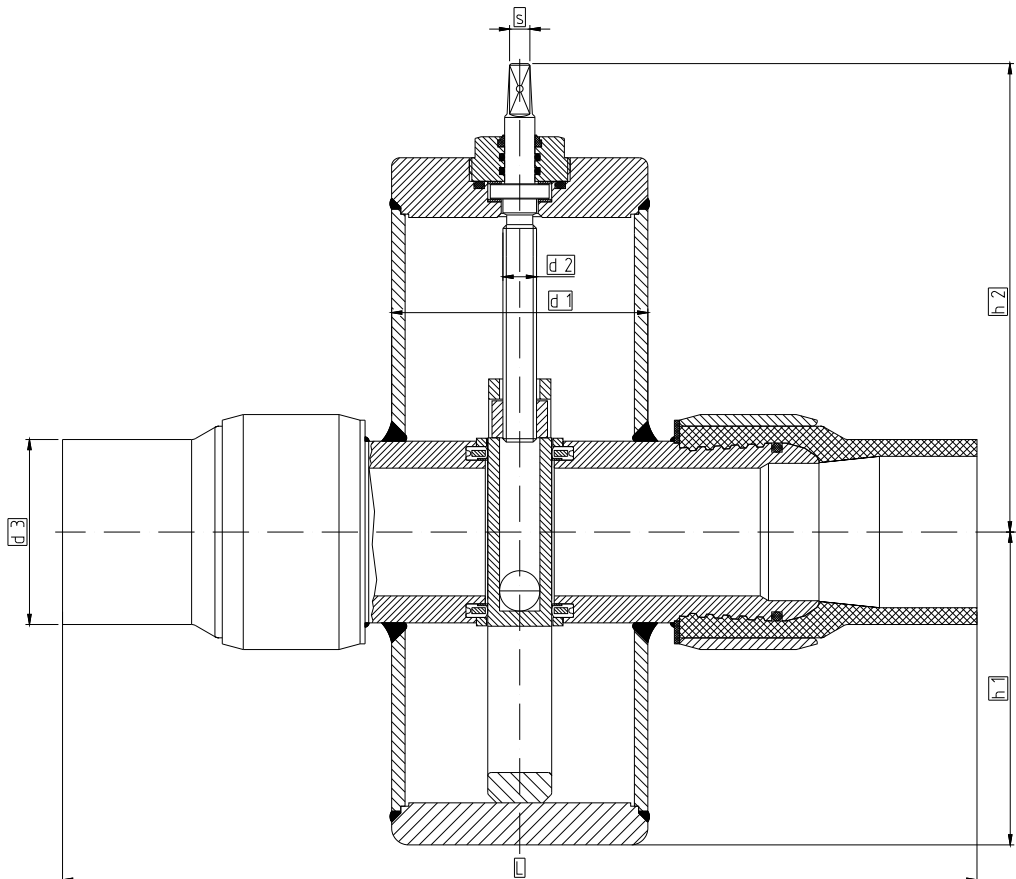

PE-Detail

With PE-connections the inside diameter of conduit gate valves is usually reduced.

The full bore size version has to be requested by customer.

The standard connection is for the PE-pipe series 5.

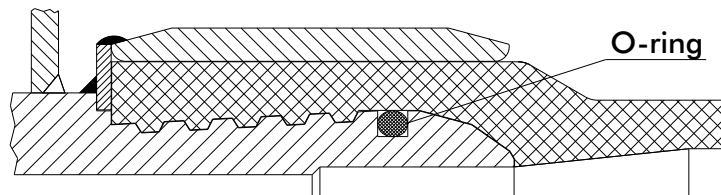

Conduit gate valve without lifting lugs

ASRW	DA 50/63	DA 90	DA 110/125	DA 160/180	DA 200/225	DA 250/280
s	12	12	12	12	12	19
d ¹	121	121	152	191	241	324
d ²	18	18	20	22	24	26
d ³	50/63	90	110/125	160/180	200/225	250/280
h ¹	129	129	179	215	312	385
h ²	229	229	279	332	425	540
L=length EN 12982 Reihe 5	600	650	740	930	1140	1140
Turn/stroke	17	17	24	24	35	45
Weight in kg	22	24	39	73	123	214